

In light of the recent concerns with the COVID-19 Corona Virus, please adhere to these best practices for cleaning MFP screens and operation panels.

For general information regarding COVID-19, visit the [CDC website](https://www.cdc.gov).

WHAT TO AVOID

Anything that contains:

- Bleach
- Ammonia
- Other harsh cleaning solvents



These products may cause the screen to become clouded, requiring replacement.

WHAT TO USE

Most types of disinfecting wipes or sprays:



Lightly moisten a cloth and gently wipe down the screen and panels with a lint-free microfiber cloth. Avoid paper towels, as they may scratch.

Using a spray bottle? DO NOT spray directly on the device's surfaces or components. Getting liquid inside the device could damage internal components.

RICOH Smart Device Connector

Allows you to operate the machine using a smart device

Copy · Print · Scan · Fax

Copy settings can be specified

Number of copies · B&W or Color · Simplex or Duplex

Frequently used settings can be saved as favorites.

Visit <https://www.ricoh.com/software/connector> for more information.

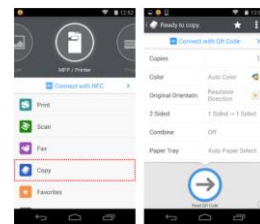

I wish I could operate the panel from my smart phone or tablet...

You can!

Available for free on Google Play and the App Store

